

Swing bolts

Steel / Stainless Steel

SPECIFICATION

Version in Steel

- Tensile strength class 5.8
- turned, thread rolled
- blackened

Version in Stainless Steel AISI 303 NI

- turned, thread rolled
- matt shot-blasted

INFORMATION

Precision type swing bolts DIN 444 are mainly used for jigs and fixtures.

For stocking purposes cylinder head shoulder bolts GN 732.1 (see page 919) can be used for the sizes M 6, M 8, M 10 and M 12.

TECHNICAL INFORMATION

- ISO-Fundamental Tolerances (see page A21)
- Stainless Steel characteristics (see page A26)
- Strength values of screws (see page A20)

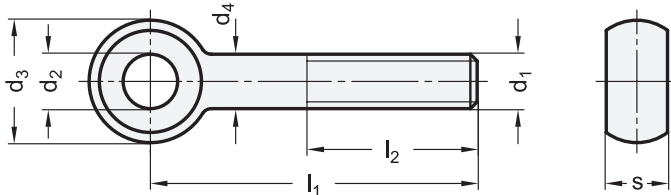

Cylinder head shoulder bolt GN 732.1 used as bearing pin

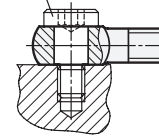

DIN 444

Description	d1	l1	l2	d2 H7	d3 -0.3	s -0.15	d4	⚖
DIN 444-M5-50	M 5	50	32	5	12	6	5	9
DIN 444-M5-75	M 5	75	32	5	12	6	5	14
DIN 444-M6-50	M 6	50	32	6	14	7	6	14
DIN 444-M6-75	M 6	75	32	6	14	7	6	19
DIN 444-M8-50	M 8	50	32	8	18	9	8	26
DIN 444-M8-75	M 8	75	32	8	18	9	8	36
DIN 444-M10-50	M 10	50	40	10	20	12	10	38
DIN 444-M10-75	M 10	75	40	10	20	12	10	53
DIN 444-M10-100	M 10	100	40	10	20	12	10	68
DIN 444-M12-75	M 12	75	40	12	25	14	12	85
DIN 444-M12-100	M 12	100	40	12	25	14	12	106
DIN 444-M12-130	M 12	130	40	12	25	14	12	110
DIN 444-M16-75	M 16	75	50	16	32	17	16	146
DIN 444-M16-100	M 16	100	50	16	32	17	16	183
DIN 444-M16-130	M 16	130	50	16	32	17	16	220
DIN 444-M20-100	M 20	100	63	18	40	22	20	305
DIN 444-M20-130	M 20	130	63	18	40	22	20	366
DIN 444-M20-160	M 20	160	63	18	40	22	20	438

DIN 444-NI

STAINLESS STEEL

Description	d1	l1	l2	d2 H7	d3 -0.3	s -0.15	d4	⚖
DIN 444-M5-50-NI	M 5	50	32	5	12	6	5	9
DIN 444-M5-75-NI	M 5	75	32	5	12	6	5	10
DIN 444-M6-50-NI	M 6	50	32	6	14	7	6	14
DIN 444-M6-75-NI	M 6	75	32	6	14	7	6	19
DIN 444-M8-50-NI	M 8	50	32	8	18	9	8	26
DIN 444-M8-75-NI	M 8	75	32	8	18	9	8	36
DIN 444-M10-50-NI	M 10	50	40	10	20	12	10	38
DIN 444-M10-75-NI	M 10	75	40	10	20	12	10	53
DIN 444-M10-100-NI	M 10	100	40	10	20	12	10	60
DIN 444-M12-75-NI	M 12	75	40	12	25	14	12	83
DIN 444-M12-100-NI	M 12	100	40	12	25	14	12	105
DIN 444-M12-130-NI	M 12	130	40	12	25	14	12	132
DIN 444-M16-75-NI	M 16	75	50	16	32	17	16	146
DIN 444-M16-100-NI	M 16	100	50	16	32	17	16	183
DIN 444-M16-130-NI	M 16	130	50	16	32	17	16	220
DIN 444-M20-100-NI	M 20	100	63	18	40	22	20	322
DIN 444-M20-130-NI	M 20	130	63	18	40	22	20	400
DIN 444-M20-160-NI	M 20	160	63	18	40	22	20	470

